

BRICO How to install the "Seat sound system" a posteriori MK3

BRICO How to install the "Seat sound system" a posteriori MK3

 by Jesus [red](#) on Sep 08, 2014, 11:30 PM

Since we are many interested even outside of Spain and we do not have information on how to carry out the installation ... I will explain a bit how to do it.

we will need :

2 2-pin connectors, one for connecting the subwoofer (4E0971942) and one for the center (1J0971972) , a pin puller (homemade), anti-heat cloth tape, 5 meters of gray / red wiring and another 5 meters of gray / brown, both 1.5mm (for the subwoofer), 1 meter of brown and 1 meter of black 0.5mm (for center), center speaker (5F0035397) and subwoofer (5F0035382), center screw for spare wheel / subwoofer (5Q0803899) 2 keys to remove glove box unit 4-pin female for **iso connectors (XBC0718400-01) and the foam where the subwoofer goes and the puncture repair kit in my case** (5F0012109B) **If you are fitting to an ST with toolkit under the spare wheel you will need a longer centre screw (5F0803899).**

running time: 1 hour approx.

budget and references: € 124 speakers, connectors, central screw and foam to locate the subwoofer and puncture repair kit.

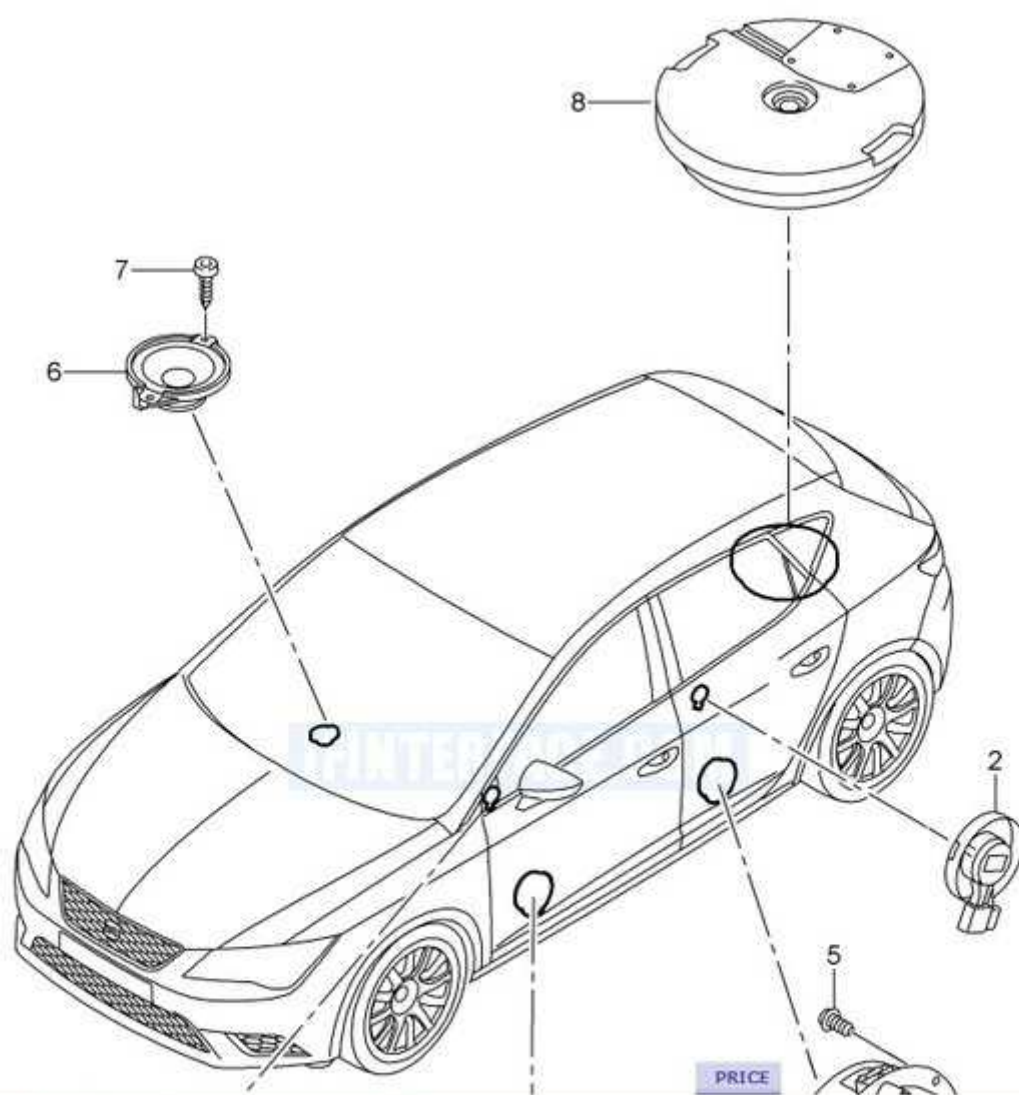

6	5F0035397	altavoz	8,66	del. central
7	N10666302	tornillo alomado p. chapa	0,27	4,2X19
8	5F0035382	altavoz de graves	62,62	trasero

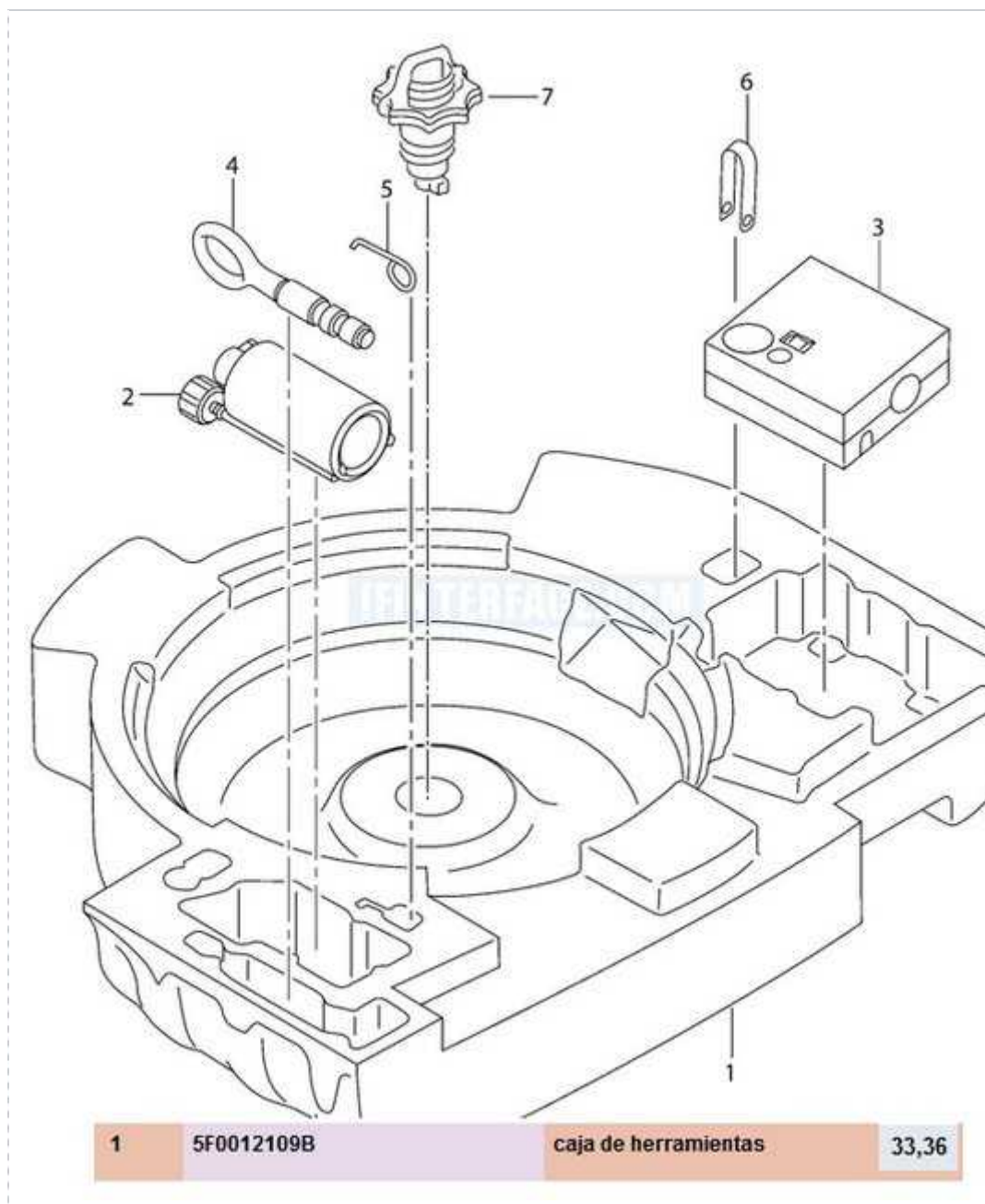

Who wants to put a spare wheel on the foam is € 9 instead of € 33, the wheel must be ordered from 18 "otherwise the subwoofer would not enter.

I carry this foam for the puncture repair kit



We replace the foam that I carry with the conditioned foam to house the subwoofer and the puncture repair kit:



this is the subwoofer



This is the screw to hold the spare wheel / subwoofer box, it is located in the center, its price does not reach € 10





First of all we should know what type of audio configuration we have, in my case it is 8RM, it is identified in the maintenance book and the sticker in the hole of the spare wheel; all this to see how we have the pins in the quadlock connector.



If someone had a different configuration than mine, I can provide the scheme.

I have made this image so that it is easier for me to know what pins the subwoofer uses

, central and those who already have the car to make the modification.

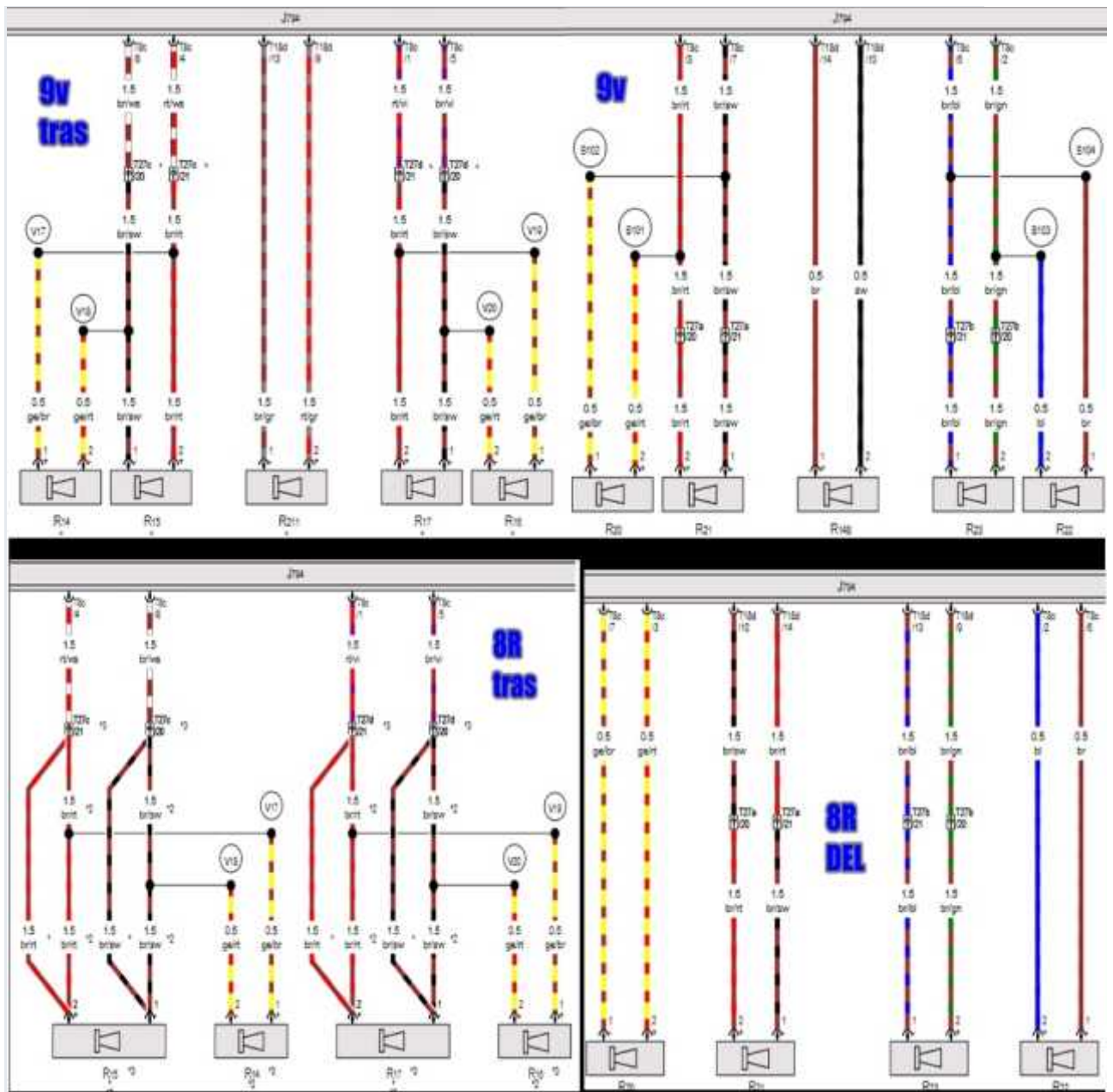

I have taken the image of my configuration and I have put aside how it should look.

steps to follow :

We remove the unit from the glove box with the help of the 2 special keys for it, that's where all the connections are.



We remove the part that covers the center speaker located at the top of the dashboard (special care with a square insert that is housed there, IT IS THE GPS ANTENNA !!)





We remove the right trim from the dashboard, which is attached to the passenger door, it will help us to pass the installation for the subwoofer.



now we put the 0.5 mm brown and black wiring through the hole of the center speaker,

previously we will have to remove the excess material from the dashboard that is in the speaker housing, covering the gap.



, now

We pass the cable to the top of the glove box where we will take it, it is easy, since the distance is very short, with this we already have the installation of the central speaker. the brown wire goes to pin 14 and the black to 10. I have put anti-heat tape on the ends. (the brown wire goes to the --negative terminal on the speaker which is marked 1 on the plug and the black wire to the +positive terminal on the speaker marked 2 on the plug, the Seat wiring diagram for the centre speaker shows the incorrect polarity markings on the centre speaker)



we place the speaker





Now we are going with the subwoofer installation, the factory installation uses gray / brown and gray / red cable, but I have had to put 1.5mm red and black parallel wiring since it was impossible for me to find the factory color code and that I have searched well. For this I have passed it through the trim on the bottom, and when I get to the boot under the carpet on the right side wall, this way we will easily reach the subwoofer. Gray / red to pin 9 and gray / brown to pin 13.
(the factory SSS wiring colours to the subwoofer are red/grey which is +positive and goes to terminal 2 on the sub and as stated pin 9 on the quadlock, the other wire is brown/grey which is --negative and goes to terminal 1 on the sub and pin 13 on the quadlock)



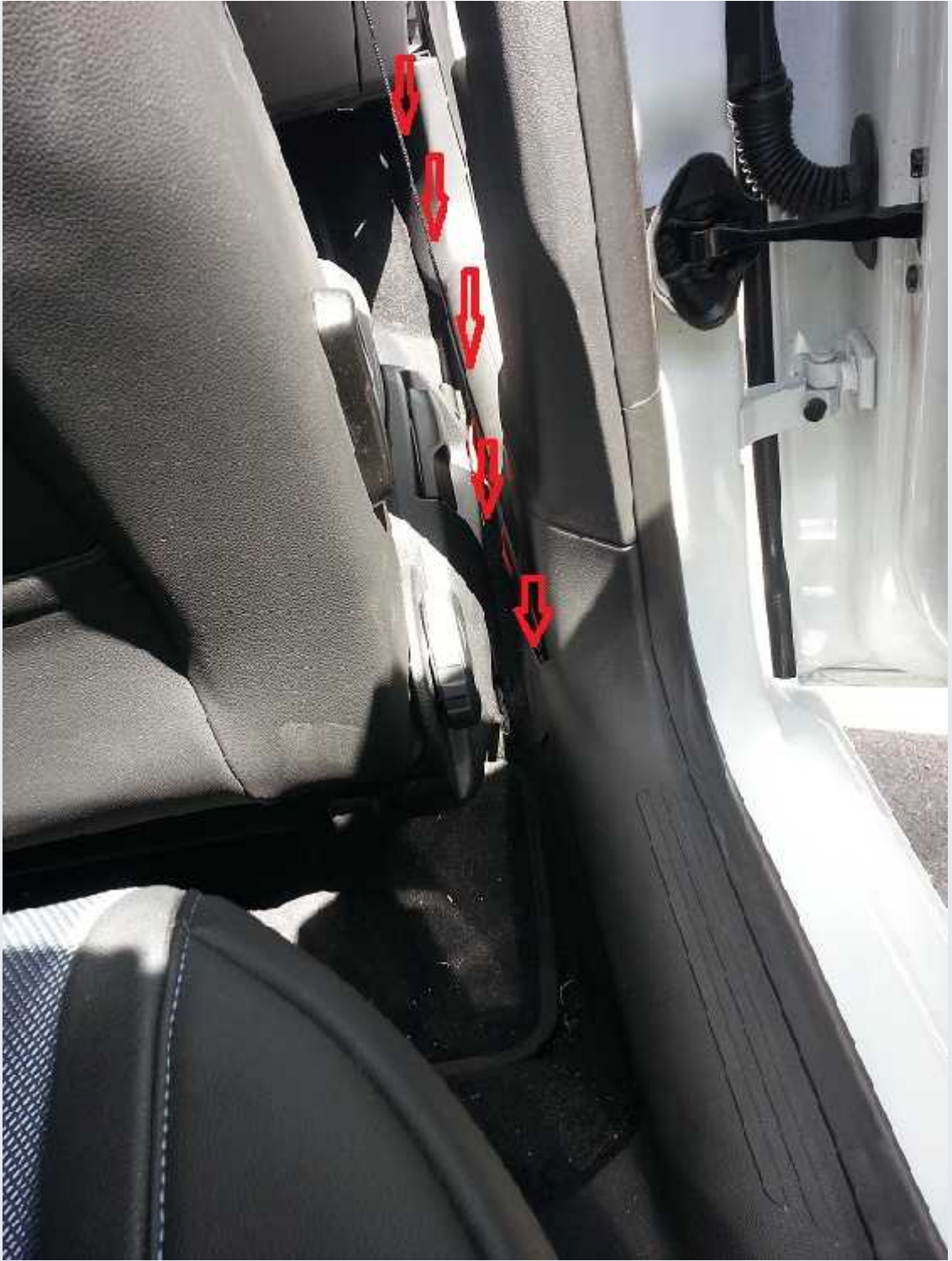







We already have the installation done, now comes the most complicated, well, not complicated, laborious rather, since as I mentioned earlier, we have occupied the pins that we have to use for the configuration that we want to use for the seat sound system.

Before removing the pins, the pink piece that locks them must be removed.

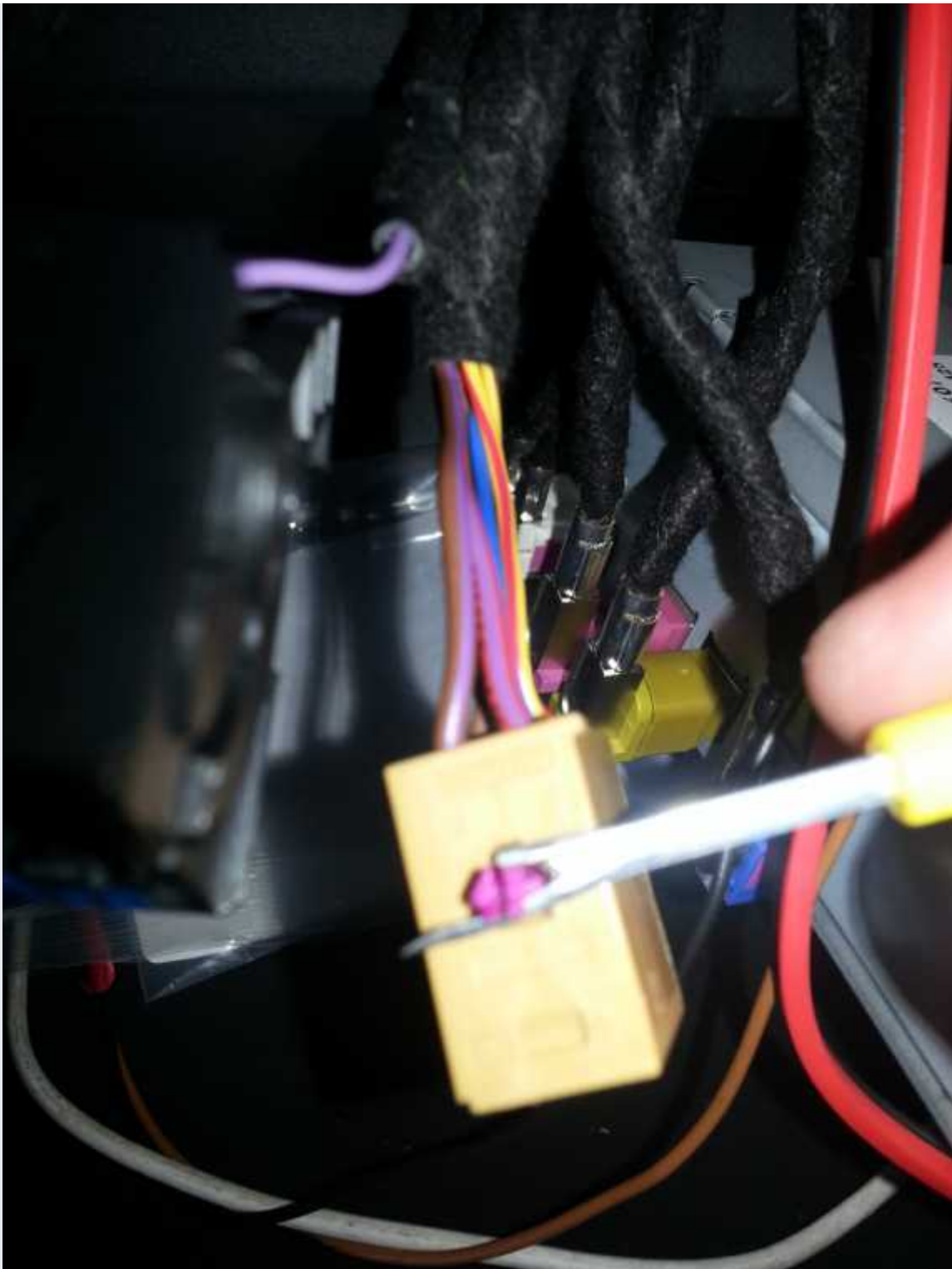

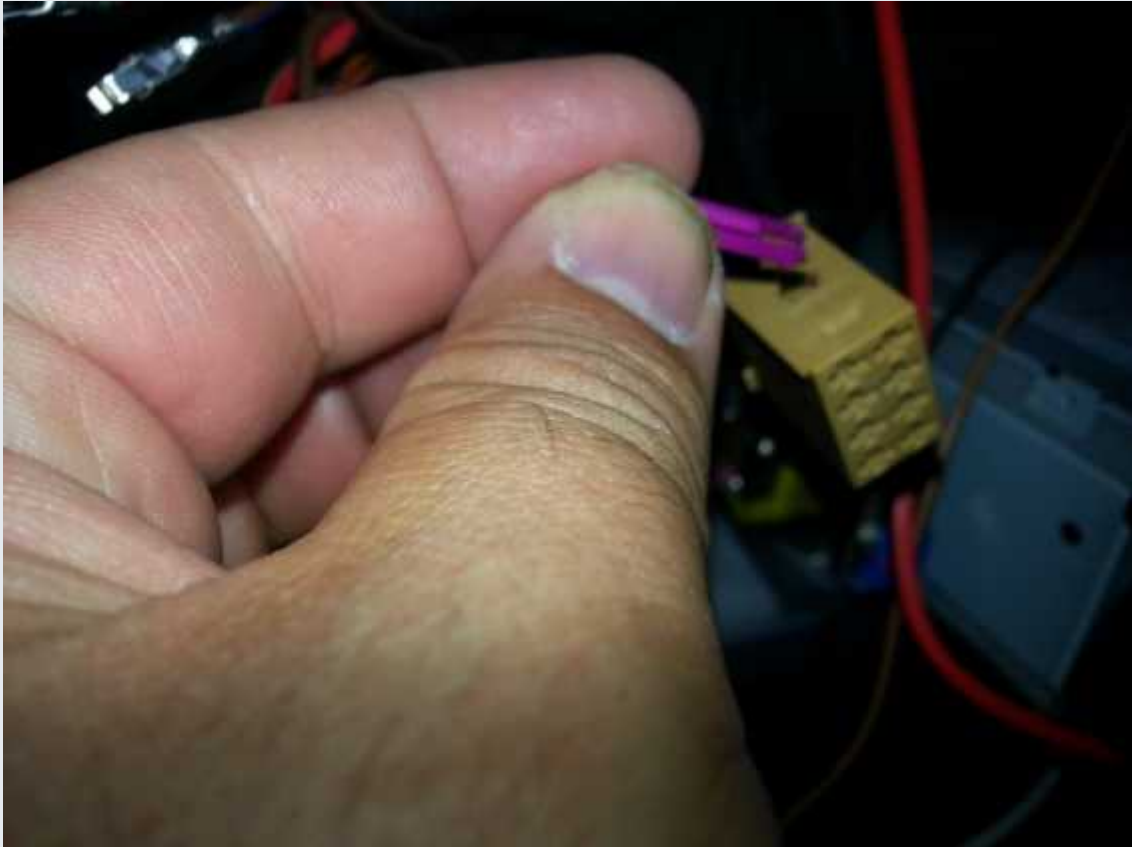

for this we will have to use the extractor to remove the 4 cables of 1.5 from that connector (black connector), there are no others, so there is no room for error, just in case I put the ones I have had to remove:

brown / blue, brown / black, brown / green and brown / red all 1.5mm



home exhaust:

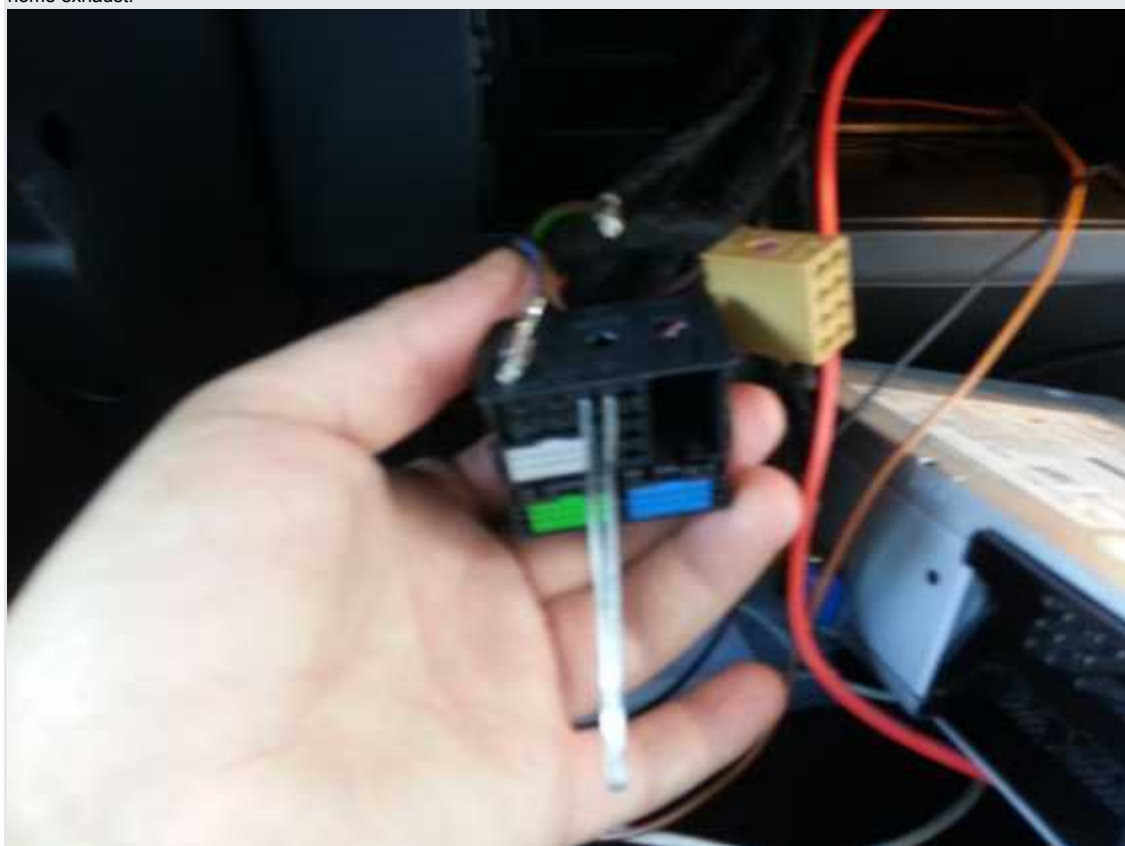



We will also remove the front trebles, they are the 0.5 mm cables brown pin 5 and blue pin 2 (brown should be pin 6)

. We will also remove the other two that we have left of 0.5 mm yellow / red pin 3 and yellow / brown pin 7 of the (brown connector)

We will have to locate the 1.5mm cables that we have removed from the 1st connector (black) and place them where the 0.5mm ones were (brown) and connect these to the 1.5mm cables to the 1.5mm cables again.



the extractor works !!!



Now I tell you the colors and the pins where they have to go:

as we have removed the 4 wires of 0.5 mm from pins 7, 3, 2 and 6 and those of 1.5 mm from pins 10, 14, 13 and 9

Lets put: (should be 1.5 brown/red with 0.5 yellow/brown on PIN 7, they are both --negative terminal wires if you have PR-8RM wiring to the quadlock connector!)
the 1.5 red / brown wire on pin 3 next to the 0.5 yellow / brown wire
the 1.5 black / brown wire on pin 7 next to the 0.5 yellow / red wire (should be brown/black & yellow/red on pin 3, both +positive)
the 1.5 blue / brown wire on pin 6 next to wire 0.5 brown wire
1.5 green / brown on pin 2 next to wire 0.5 blue

We put the 4 female terminals on the 2 cables of the subwoofer and the 2 of the central one.

These will now go to the black connector where the 4 1.5 mm cables were before, as follows:

the red / gray 1.5 subwoofer cable on pin 9 the brown / gray 1.5
subwoofer cable on pin 13

the black 0.5 wire from the control panel on pin 10 the brown 0.5
cable from the control panel on pin 14

We already have everything correctly connected.

I have put anti-caloric cloth tape on the cables so as standard. I have manufactured my pin extractor, with simple tweezers, I have filed them until they are finite, so that it enters the 2 holes of the connector on the front, its function is to simultaneously press the two tabs q has the terminal so that it can exit.



here the reference and how to put the subwoofer connector, I bought it at audi since it is the same and did not have the reference in seat:

M. CONDE PREMIUM, S.L.

Servicio Oficial 0300X



Número de Factura: AC1450708

Fecha de Factura: 10/09/14

Vendedor: 3

Número de Página: 1 de 2

CIF / NIF:

C.C.: 000000

Tipo Factura: Cargo

Ma.	Referencia	C.I.	Denominación	Cant.	PVP Unit.	Dto.	Importe Neto
11	4ED 921 942	DA	CAJA	1	1,76		1,76
11	PWES	DA	KUJET	2	0,15		0,30

M. Conde Premium, S.L.
www.mcondepremium.comTodas nuestras ofertas en la
palma de la mano.Escaneame con el lector de
códigos QR/índex para más
información.Aguacate, 45
28054 Madrid
Vendas: 91 511 08 50
Fax: 91 528 40 18
Recambios: 91 528 12 18
Caja Postal: 91 528 11 53









I hope or help anyone who decides to ride it.

I can only code to activate the control of the subwoofer on the screen, although the new components of the super car really work !! I like the way it sounds!

and for a little money



[Red Jesus](#)